

WWW.**BUYDEEM**.COM



Scan Buydeem
WeChat for free recipe

Shenzhen Crastal Technology Co., Ltd.

Address: 8/F, Block A7, Nanshan iPark, 1001 Xueyuan Road, Taoyuan Street, Nanshan District, Shenzhen City, China
Email: support-US@buydeem.com

K2684-01-A1
In case of any minor changes, please refer to the real product.

BUYDEEM



Health-care Beverage Maker K2684 Operation Instruction

*Please read this instruction before use and visit www.buydeem.com for more information.

CONTENTS

I. Safety Precautions	2
II. Technical Specifications	3
III. Product Instruction	4
1. Product Structure Diagram	4
2. Function Introduction	5
3. Glass Stew Pot Introduction	7
IV. Usage Of Product	8
1. Initial Use	8
2. Quick Installation	8
3. How To Use	9
4. Special Functions	17
V. Cleaning And Maintenance	20
VI. Troubleshooting	21
VII. Warranty And Service	22

Thank you for purchasing Buydeem Health-care Beverage Maker. Please read this manual and the relevant illustrations thoroughly before use and keep in a safe place for further reference.

Safety Precautions

IMPORTANT SAFEGUARDS

When using electrical appliances, basic safety precautions should be followed, including the following:

1. Read all instructions.
2. Do not touch hot surfaces. Use handles or knobs.
3. To protect against fire, electric shock and injury to persons do not immerse cord, plugs, kettle body & base in water or other liquid
4. Close supervision is necessary when any appliance is used by or near Children.
5. Unplug from outlet when not in use and before cleaning. Allow to cool before putting on or taking off parts, and before cleaning the appliance.
6. Do not operate any appliance with a damaged cord or plug or after the appliance malfunctions, or has been damaged in any manner.
7. The use of accessory attachments not recommended by the appliance manufacturer may result in fire, electric shock or injury to persons.
8. Do not use outdoors.
9. Do not place on or near a hot gas or electric burner, or in a heated oven.
11. Always attach plug to appliance first, then plug cord into the wall outlet. To disconnect, turn any control to 'OFF' then remove plug from the wall outlet.
12. Do not use appliance for other than intended use.
13. Scalding may occur if the lid is removed during the brewing cycles.
14. Open the covering lid through the lid handle only. Then store it well for placement.
15. Caution: do not immerse in water.
 - A: The container is designed for use with this appliance. It must never be used on a range top.
 - B: Do not set a hot container on a wet or cold surface.
 - C: Do not use a cracked container or a container having a loose or weakened handle.
 - D: Do not clean container with cleansers, steel wool pads, or other abrasive material.

Catalog

Extreme caution must be used when moving an appliance containing hot oil or other hot liquids.

Avoid sudden temperature changes, such as adding refrigerated foods into a heated pot.

SAVE THESE INSTRUCTIONS:

Note: This electrical appliance is for Household use only.

Power cord

A short power-supply cord is provided to reduce risks resulting from becoming entangled in or tripping over a longer cord.

Long extension cords are available and may be used if care is exercised in their use.

If a long extension cord is used:

- 1) The marked electrical rating of the extension cord should be at least as great as the electrical rating of the appliance;
- 2) If the appliance is of the grounded type, the extension cord should be a grounding type 2-pin cord;and
- 3) The longer cord should be arranged so that it will not drape over the counter top or table where it can be pulled on by children or tripped over.

Technical specifications

Product name: Health-care Beverage Maker

Model: K2684

Power: 1000 W

Voltage:120 V~60 HZ

Maximum capacity: 1.5 L

SUS304 and SUS316 stainless steel for food contact is adopted.

Product Introduction

Product Structure Diagram

1. Tea basket lid
2. Filtering tea basket
3. Kettle cover
4. Kettle body
5. Stay-cool Handle
6. Operation power base
7. Stew function knob
8. Stew pot bracket cover
9. Inner cap of the glass stew pot
10. Glass stew pot
11. Stew pot bracket holder

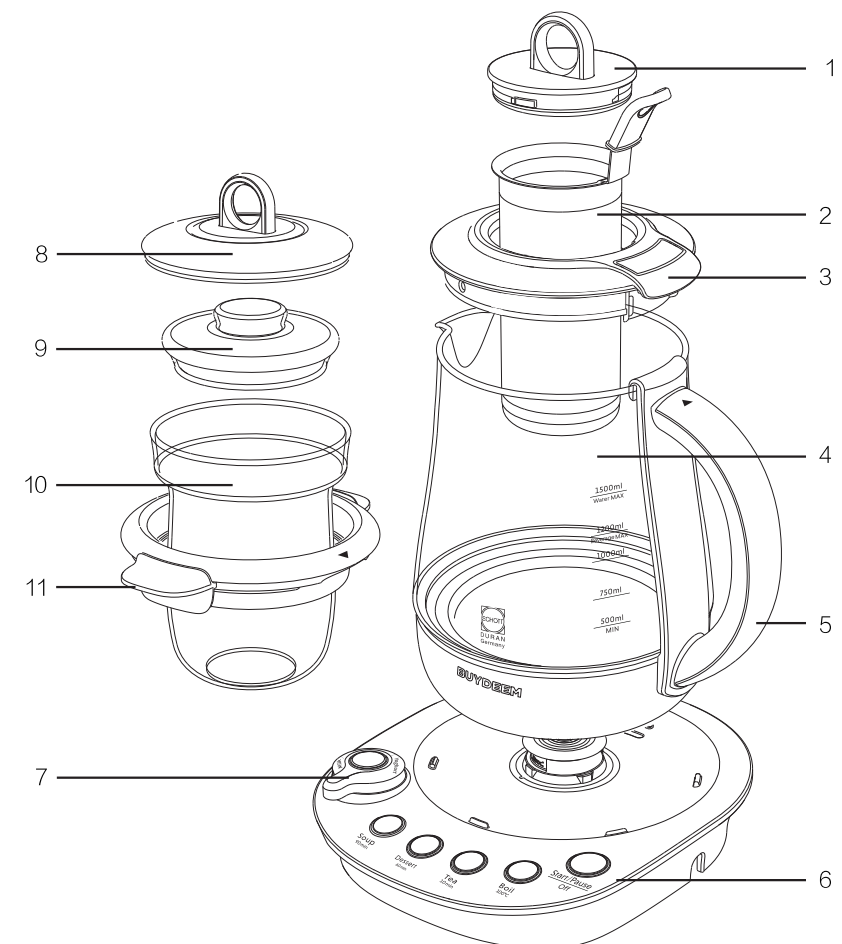

Product Introduction

Function introduction

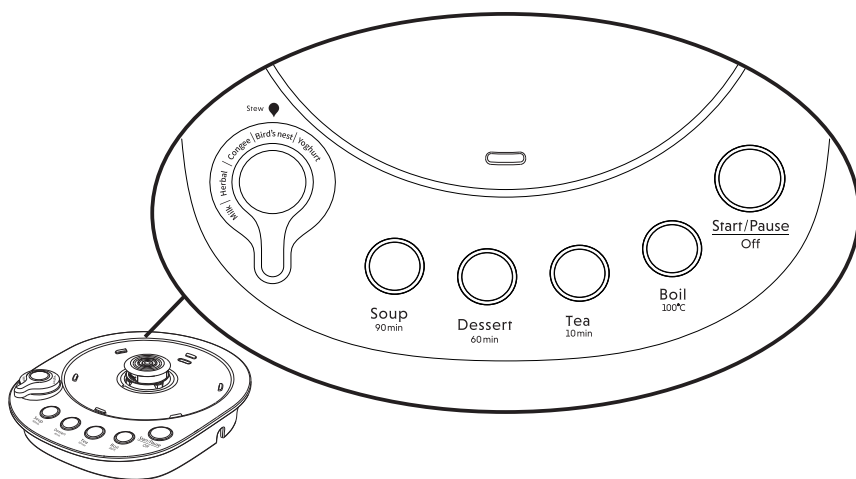

Start / Pause (Off)

This button is normally on when it is working, but would blink when paused. You can press the button of "start / pause" when the Health-care Beverage Maker is working and it is suspended after button flashing, and starts to work if it is pressed again when the button is on. If you need to cancel the set function or shut down, just press this button for two seconds, the Health-care Beverage Maker will stop working and enter the standby mode after the button is completely off. If you need to switch to other function modes after the Health-care Beverage Maker works for one minute, please press the "start / pause" button and select other functions.

Boil

This function is used for boiling water. If selected, the Health-care Beverage Maker is heated quickly to boil. The kettle would give a 'beep' tone when boiling, then stop running automatically and enters the standby mode.

Tea (10 min)

This function is used to make flower tea, fruit tea, blending tea, and other teas. If selected, the Health-care Beverage Maker is heated quickly to boil and works in accordance with this pattern for 10 minutes. Then, the kettle will give a "beep" tone, which means that the work is finished and it will be automatically kept to 70°C for 2 hours. 2 hours later, the Health-care Beverage Maker stops completely and enters standby mode.

Dessert (60 min)

This function is used for cooking beans, red dates, lotus seeds, and other materials. If selected, the Health-care Beverage Maker is heated quickly to boil and works in accordance with this pattern for 1 hour. Then the kettle will give a "beep" tone, which means that the work is finished and it will be automatically kept to 70°C for 2 hours. 2 hours later, the Health-care beverage maker stops completely and enters standby mode.

Product Introduction

Soup (90 min)

This function is used for cooking Chinese soup, pearl barley and other nourishing soup. If selected, the Health-care Beverage Maker is heated quickly to boil and works in accordance with this pattern for 1.5 hours. Then the kettle will give a "beep" tone, which means that the work is finished and it will be automatically kept to 70°C for 2 hours. 2 hours later, the Health-care Beverage Maker stops completely and enters standby mode.

Stew function knob (the following functions are used with the stew pot)

Milk [60°C /10 minutes]

This function is used in conjunction with the stew pot to warm the milk for drinking. If selected, the water in the Health-care Beverage Maker is heated and kept to 60°C. 10 minutes later, the kettle will give a "beep" tone, which means that the work is finished and enters standby mode.

Herbal [120 minutes]

This function is used in conjunction with the stew pot to stew dendrobium, lucid ganoderma and other herbal diet. If selected, the Health-care Beverage Maker is heated quickly to boiling and works in accordance with this pattern for 2 hours. Then, the kettle will give a "beep" tone, which means that the work is finished and it will be automatically kept to 70°C for 2 hours. 2 hours later, the Health-care Beverage Maker stops completely and enters standby mode.

Congee [60 minutes]

This function is used in conjunction with the stew pot to stew millet congee, vegetable congee and other congee. If selected, the Health-care Beverage Maker is heated quickly to boil and works in accordance with this pattern for 1 hour. Then, the kettle will give a "beep" tone, which means that the work is finished and it will be automatically kept to 70°C for 2 hours. 2 hours later, the Health-care beverage maker stops completely and enters standby mode.

Bird's Nest [30 minutes]

This function is specially used in conjunction with the stew pot to stew Bird's Nest. If selected, the Health-care Beverage Maker is heated quickly to boil and works in accordance with this pattern for 30 minutes. Then, the kettle will give a "beep" tone, which means that the work is finished and automatically stops, and enters standby mode (it has no automatic keep warm for this pattern to avoid Bird's Nest from melting into water).

Yoghurt [40°C /12 hours]

This function is used in conjunction with the stew pot to make yoghurt. If selected, the water in the Health-care Beverage Maker is heated and kept to 40°C for 12 hours in accordance with this pattern. Then the kettle will give a "beep" tone, which means that the work is finished and automatically stops, and enters standby mode.

Product Introduction

Introduction of the filtering tea basket

The design of 'lid in lid'

A unique design of "lid in lid" with two nested lids is adopted for the Health-care Beverage Maker according to the user's daily using preference. The user can observe the cooking at any time through unscrewing the cover during normal running of the tea basket, so as to choose to feed in ingredients or add flavoring and perform other operations. If a lot of foam is produced during functioning, it is recommended that the tea basket be opened to prevent spillage.

1. Installation of the filtering tea basket: ①Grab the handle of the tea basket and put it into the hollow part of the pot cover; ②Tighten the tea basket cover clockwise, and it had tightened when a slight sound of "tick" is heard.

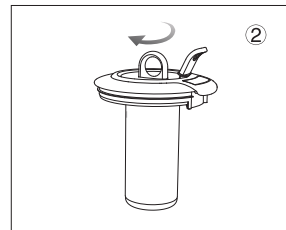
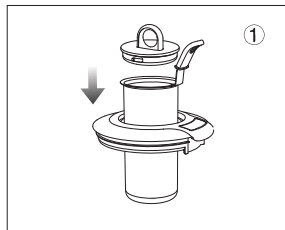

2. Disassembly of the filtering tea basket: ①Unscrew the tea basket cover counter clockwise; ②Grab the tea basket handle and bring it out.

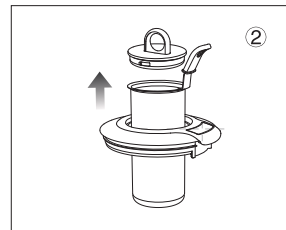
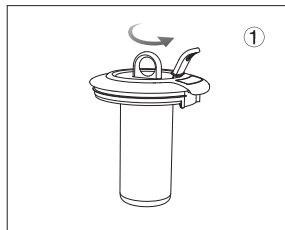

Product Introduction

Introduction of the glass stew pot

Design of the stew pot

In addition, a unique design of scaffolding stew pot is added to the Health-care Beverage Maker to meet the more comprehensive daily using requirements of users. Users can stew foods separately with water and directly observe the cooking state through the glass.

⚠ Note: Please do not pour water when using the stew pot bracket to avoid the scald caused by the fall of stew pot and holder.

1. Installation of the glass stew pot: ①Place the stew in the bracket; ②Lift the bracket together with the stew pot; ③Install on the Health-care beverage maker and cover the outer lid of the bracket; ④The installation has been completed when the triangle mark on the bracket is aligned with the one on the handle of the glass body.

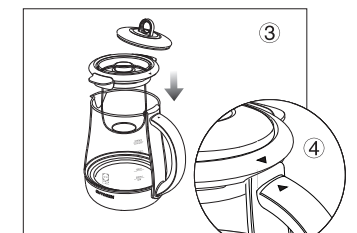
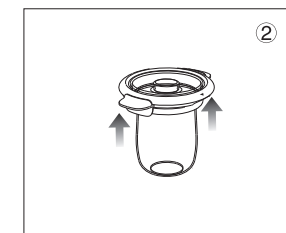
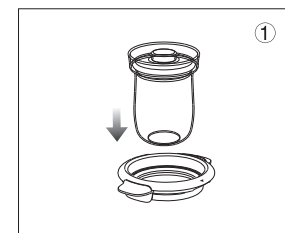

2. Disassemble of the glass stew pot: ①Lift the bracket and bring it out with the stew pot; ②Lay down the bracket gently; ③Take the outer lid off the bracket and remove the stew pot.

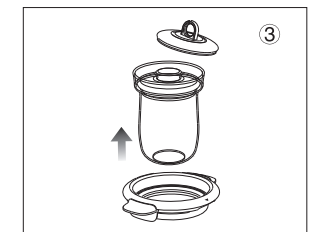
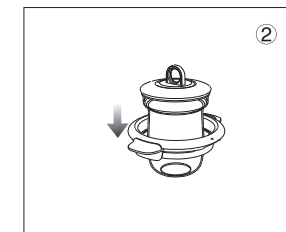
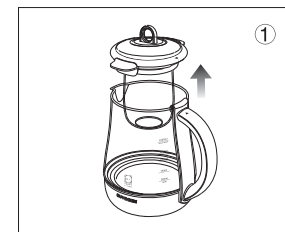

Usage of product

Initial use

1. Remove all the packaging, labels and accessories inside and outside the Health-care Beverage Maker. It is recommended to do a boiling point test (see P17) before the initial use of the product.
2. Boiled water for the first 2 to 3 times should be drained for cleaning, and then wipe the external parts with a wet cloth.

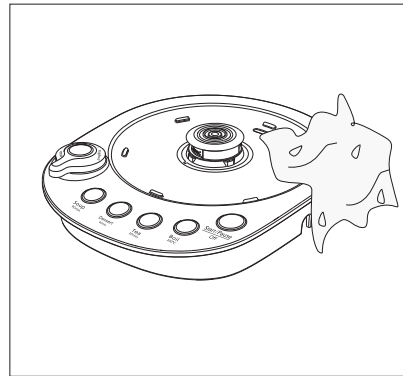
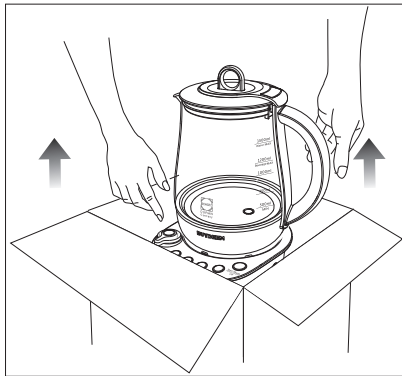

Quick installation

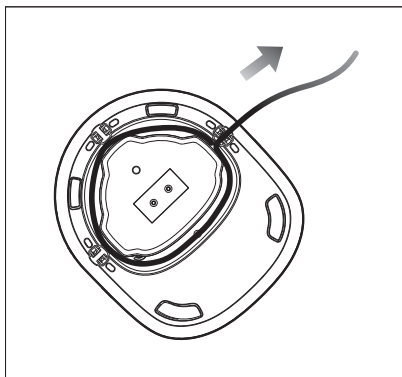

1. Adjust the length of the power cord through the winding device of the base.

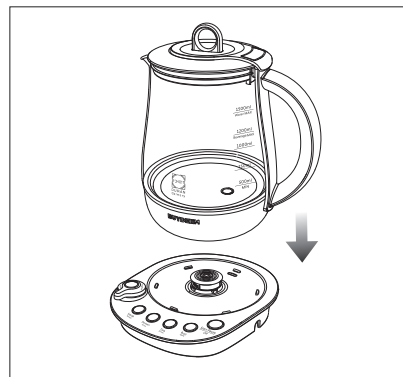

2. Put the kettle on the base.

Usage of product

How to Use

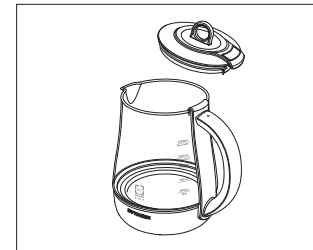

- I. Open the kettle lid
 - Grasp the handle of the kettle lid and pull it up to open the cover.

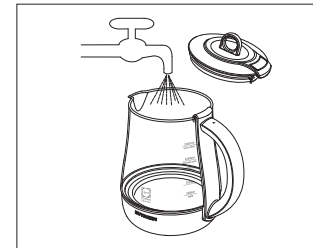

- II. Add proper amount of pure water
 - Don't add water when the pot is on the base.



- III. Add the ingredients
 - Never add water and ingredients over the maximum or below the minimum water level.
 - It may splash water if overfilling when boiling.
 - Please be noted that it is recommended to add water to 1200ml for tremella, astragalus, black tea and other easily foamed ingredients, and open the lid when working.

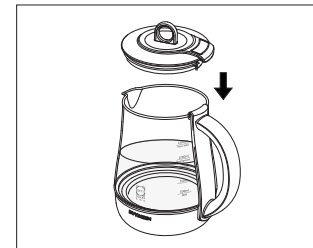

- IV. Close the lid
 - Place the lid on the kettle as shown. Press lightly to close the lid and gently lift it with your hands. If it cannot be lifted up, it means the lid is tight.
 - If the lid assembly is not in place, it will fall easily when pouring water.

Usage of product

How to Use



- V. If the glass stew pot is needed
-Put the ingredients into the stew pot and add some water.
Make an installation as shown on the page 8.

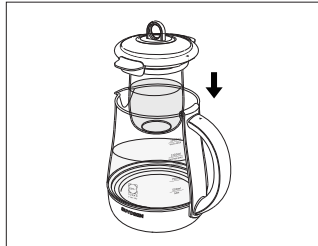

- VI. Installation of the kettle lid
-Lift the bracket together with the stew pot and install it on the kettle.
-For your attention! Please make sure the triangle mark on the bracket aligns with the one on the handle of the glass body, otherwise, it is not installed properly.

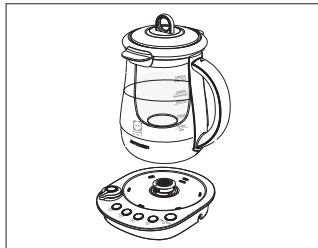
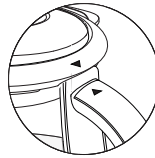

- VII. Put the kettle on the base
-Please dry the water at the bottom of the pot and on the base.
-The base must be placed on a flat, clean, heat-resistant table.
-Exclusive base must be used with the body of the Health-care beverage maker.
-Do not use if there is no water in the kettle.

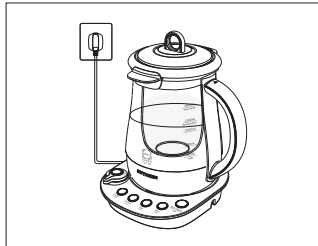

- VIII. Plug in the power
-When the kettle is energized, the buzzer makes a noise, the button light flashes and turns off later, indicating that the device is in standby mode, and the function can be started.

Usage of product

Boiling

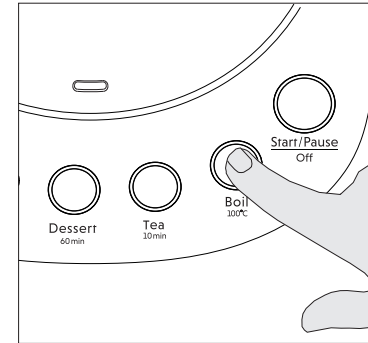

Two ways to enter the mode of boiling water:

1. Press the 'Boil' button, and then the 'Start/Pause' button, the mode of 'Boil' starts.
Note: After pressing the 'Boil' button, the light turns on and the 'Start/Pause' button flashes, which prompts the need to press it. Then it enters the mode of 'Boiling' with the 'Start/Pause' button light turns on after press.
2. Press the 'Start/Pause' button, then the 'Boil' button to start the mode of 'Boil'.
Note: Firstly press the 'Start/Pause' button, it turns on and other function button lights turn off after flashing, which prompts to start selection of function. Then it enters the mode of 'Boil' with the 'Boil' button light turns on after press.

Usage of product

Tea

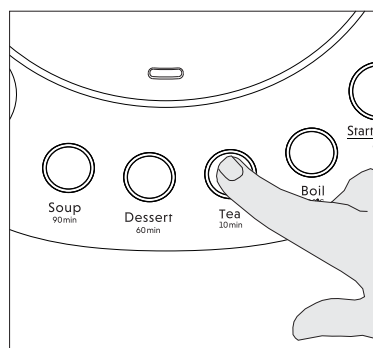

Two ways to enter the mode of 'Tea':

1. Press the 'Tea' button, and then the 'Start/Pause' button, the mode of 'Tea' starts.

Note: After pressing the 'Tea' button, the light turns on and the 'Start/Pause' button flashes, which prompts the need to press it. Then it enters the mode of 'Tea' with the 'Start/Pause' button light turns on after press.

2. Press the 'Start/Pause' button, then the 'Tea' button to start the mode of 'Tea'.

Note: Firstly press the 'Start/Pause' button, it turns on and other function button lights turn off after flashing, which prompts to start selection of function. Then it enters the mode of 'Tea' with the 'Tea' button light turns on after press.

Usage of product

Dessert

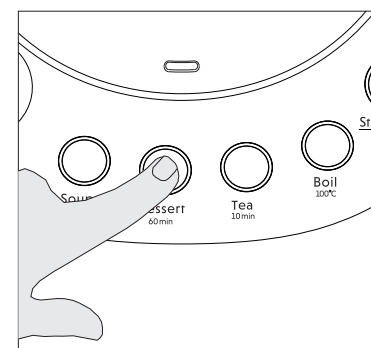

Two ways to enter the mode of 'Dessert':

1. Press the 'Dessert' button, and then the 'Start/Pause' button, the mode of 'Dessert' starts.

Note: After pressing the 'Dessert' button, the light turns on and the 'Start/Pause' button flashes, which prompts the need to press it. Then it enters the mode of 'Dessert' with the 'Start/Pause' button light turns on after press.

2. Press the 'Start/Pause' button, then the 'Dessert' button to start the mode of 'Dessert'.

Note: Firstly press the 'Start/Pause' button, it turns on and other function button lights turn off after flashing, which prompts to start selection of function. Then it enters the mode of 'Dessert' with the 'Dessert' button light turns on after press.

Usage of product

Soup

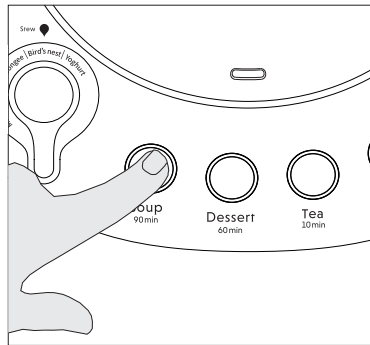

Two ways to enter the mode of 'Soup':

1. Press the 'Soup' button, and then the 'Start/Stop' button, the mode of 'Soup' starts.

Note: After pressing the 'Soup' button, the light turns on and the 'Start/Stop' button flashes, which prompts the need to press it. Then it enters the mode of nourishing soup with the 'Start/Stop' button light turns on after press.

2. Press the 'Start/Stop' button, then the 'Soup' button to start the mode of 'Soup'.

Note: Firstly press the 'Start/Stop' button, it turns on and other function button lights turn off after flashing, which prompts to start selection of function. Then it enters the mode of 'Soup' with the 'Soup' button light turns on after press.

Usage of product

Stew function

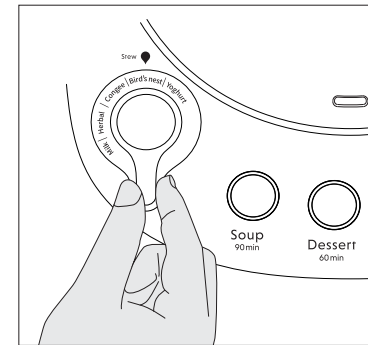

Two ways to start 'Stew' mode with the function knob:

Take the "Bird's Nest" function as an example.

1. Turn the knob to the "Bird's Nest", and then press the 'Start/Stop' button, the mode of 'Bird's Nest' starts.

Note: Turn the knob to the 'Bird's Nest', the function knob light turns on and the 'Start/Stop' button flashes. Then it enters the mode of 'Bird's Nest' with the 'Start/Stop' button light turns on after press.

2. Press the 'Start/Stop' button, then turn the knob to the 'Bird's Nest' to start the mode of 'Bird's Nest'.

Note: Firstly press the 'Start/Stop' button, it turns on and other function button lights turn off after flashing. Then it enters the mode of 'Bird's Nest' with the button light turns on after turning the knob to the 'Bird's Nest'.

Special function

Memory program for Boiling Point Test

- It cannot reach 100°C when boil water in the non-zero elevation area, which will cause failure of work properly(break off too slow or even unable to trip normally) for the ordinary Health-care Beverage Maker.
- In order to ensure a good using experience for the user on the plateau, an industry's advanced boiling point testing technology with the built-in memory chip is adopted by Buydeem Health-care Beverage Maker, which can be used normally in the plateau area by just performing a boiling point test.
- The boiling point test is not limited to the plateau area, but also applicable to the plain or mountainous areas. After the boiling point test, the Health-care Beverage Maker can work more accurately (better performance than the factory setting).It is recommended to carry out a boiling point test for the initial use. Upon completion of the test, the chip will record accurate boiling point data and there is no need for a repeated test when reuse.

Start of the Boiling Point Test

1. Add 1200ml water and it will affect the test result if there is not enough water or too much water.
2. Put on the power base with it unplugged.

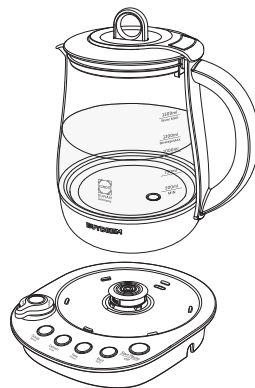
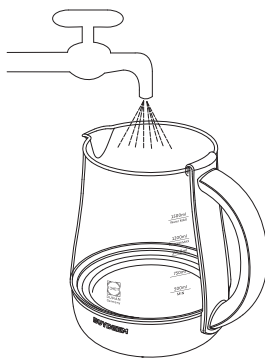

Special function

3. Press on the buttons of 'Boil' and 'Tea' at the same time, and plug in the power cord. And you can release the button after a short beep.

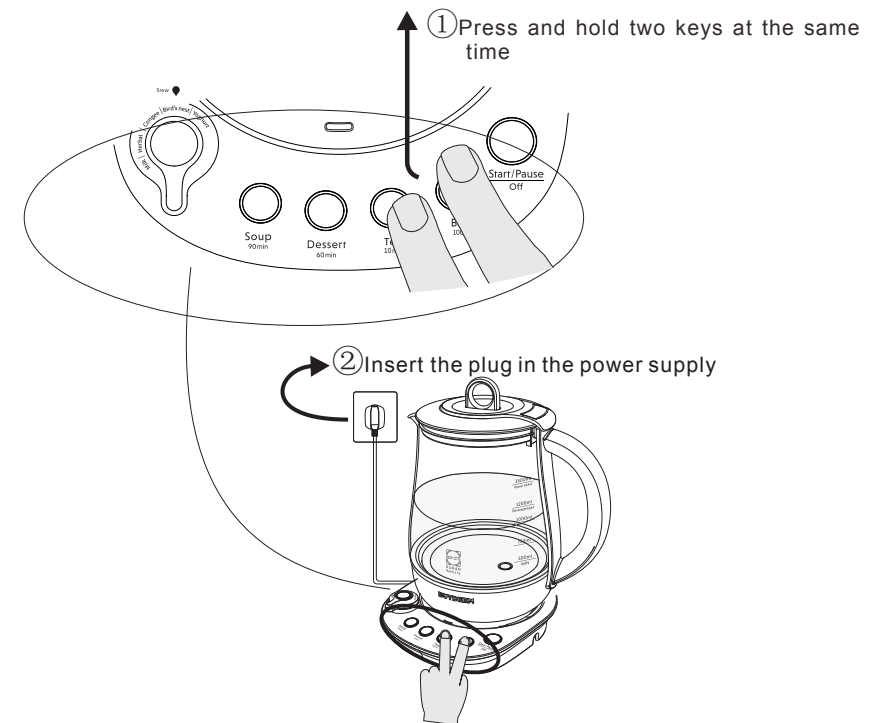

4. The light ring of 'Start/Pause' button blinks at this point, and all button indicators blink in turns after pressing the "Start/Pause' button. The machine enters the working status to test the boiling point and finishes automatically after three beeps, then the Health-care Beverage Maker can be used.

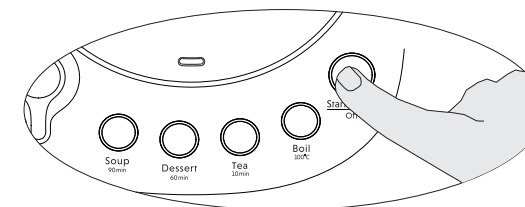

Special function

Program memory function

When the Health-care Beverage Maker is functioning, it can be paused by lifting the kettle body or press the 'Start/Pause' button, the program can be resumed if the kettle is put back on the power base or by pressing the 'Start/Pause' button within 1 hour and it will not start from the beginning again.

Avoid false operation

- The function mode can be arbitrarily switched within one minute after the selected function starts to work.
- The function cannot be arbitrarily switched after one minute's work of the Health-care Beverage Maker to avoid unintentional operations. Press the 'Start/Pause' button if you need to switch function and the button will start falshing, then select the needed program.

Cold water protection

- If the cold water is added to the kettle while the Health-care Beverage Maker is working, besides the 'Milk' and 'Yoghurt' function, the Health-care beverage maker will automatically re-boil the water and then implement the program that has not been completed.

Cleaning and maintenance

Cleaning and maintenance

Cleaning of the Health-care Beverage Maker

1. Unplug the power cord.
2. Use a wet sponge to clean the internal part after the Health-care Beverage Maker is completely cooled.
Caution: do not immerse the kettle, the base, the power cord or the plug in the water (the electronic connector on the bottom of the kettle and the power base should be kept away from water).
3. Please clean in time after every use to avoid food deterioration.

Descaling

A regular scaling is needed for the Health-care Beverage Maker(at least once a month), and the times should be increased if the water quality is not good.

It belongs to the normal phenomenon for a spot appears on the heating plate, which is the scale and can be cleaned by using a clean cloth to scrub gently. The following ways can be used for descaling in case of worse situations.

Tips for descaling of the Health-care Beverage Maker

Use white vinegar:

- Add appropriate amount of white vinegar into the Health-care Beverage Maker.
- Leave it for 1 hour without heating.
- Empty the kettle and wash it for 5-6 times with clean water. Repeat if necessary.

Use citric acid:

- Add appropriate amount of water and boil.
- Add 25g citric acid and leave it for 15 minutes.
- Empty the kettle and wash it for 5-6 times with clean water. Repeat if necessary.

Troubleshooting

Troubleshooting

When being placed on the base, the kettle works with no sound and the LED makes no action.

- Check whether the kettle is fully connected to the base.
- Check whether the base is fully connected to the power supply.

The kettle keeps beeping and the button light is not on.

- Probably because the Health-care Beverage Maker starts without water or due to scale accumulation, which triggers dry burning safety system. The cold water can be poured into the Health-care Beverage Maker after the kettle is cooled for a few minutes.

Peculiar smell in water

- It usually occurs for the new Health-care Beverage Maker unused, boiled water of the first several times should be drained. If the situation continues, fill the water to the highest water level and add two teaspoons of soda, boil, drain, and then clean the kettle.

Warranty and service

Warranty and service instructions

Buydeem warrants, subject to the conditions stated below, that from the date of purchase, this product will be free from mechanical defects for a period of ONE (1) year. Buydeem, at its option, will repair or replace this product found to be defective during the warranty period. Should this product become defective by reason of improper workmanship or material defect during the specified warranty period, Buydeem will repair or replace the same effecting all necessary parts replacements for a period of one year from the date of purchase. If product is no longer available we will replace it with a product of equal value. Transportation charges on parts, or products in whole, submitted for repair or replacement, under this warranty, must be borne by the purchaser. This warranty is void if the product is used for other than single-family household use or subjected to any voltage and waveform other than as specified on the rating label (e.g., 120V ~ 60 Hz). This warranty is available to consumers only.

CONDITIONS: This warranty is valid for the original USA and Canada retail purchaser from the date of initial retail purchase and is not transferable. warranty service would NOT apply if the product damage occurred because of misuse, lack of routine maintenance, shipping, handling, 3rd party warehousing or improper installation.

HOW TO OBTAIN WARRANTY SERVICE: If your BUYDEEM Health-care Beverage Maker should prove to be defective within the warranty period, we will repair it, or if we think necessary, replace it. To obtain warranty service, simply email support-US@buydeem.com for additional information from our Customer Service Representatives.

北鼎
WWW.BUYDEEM.COM



扫描北鼎微信
免费获取食谱

深圳市北鼎科技有限公司

地址:深圳市南山区桃源街道学苑大道1001号南山智园A7栋8楼
邮箱:service@buydeem.com
服务热线:4008-815-820

K157-91-A4
产品如有细微改动, 请以实物为准。

BUYDEEM 北鼎



多功能电水壶 (养生壶)

K157使用说明书

* 使用本产品之前请详细阅读本说明书, 更多请登陆www.buydeem.com

CONTENTS

索引

一、注意事项	2
二、技术规格	3
三、认识产品	4
1. 产品结构图	4
2. 功能模式介绍	5
3. 玻璃炖盅介绍	7
四、使用产品	8
1. 初次使用	8
2. 快速安装	8
3. 使用指引	9
4. 特色功能	17
五、清洁和保养	20
六、简单故障处理	21
七、保修和服务	22
八、保修卡	23

感谢您购买北鼎产品，为了能让您充分享受北鼎全方位的支持，使用本产品之前请详细阅读本说明书及相关图解。

注意事项

⚠ 危险

- 切勿将养生壶、底座、电源线及插头置于水中或其它任何液体中。
- 请勿在使用炖盅支架时进行倒水操作，以免炖盅与支架掉落造成烫伤危险。
- 请勿将玻璃炖盅直接明火加热。
- 请勿将玻璃炖盅放入烤箱或微波炉内加热。
- 炖盅的最大容量为480ml（约炖盅高度7成），使用时请勿超出最大容量，以免使用过程中食材溢出炖盅造成烫伤。

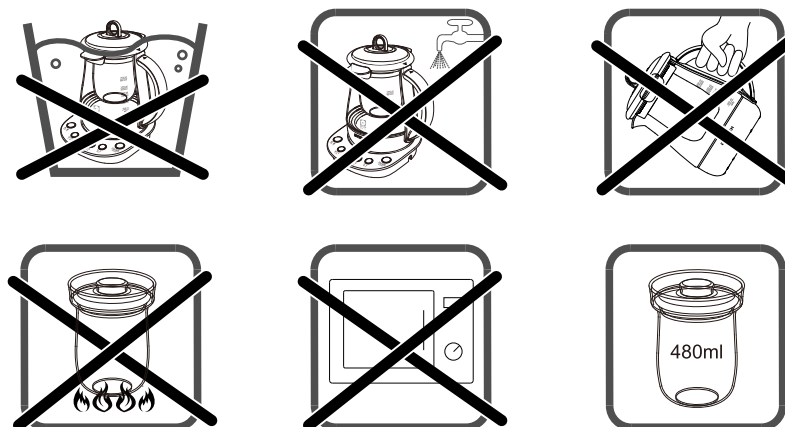

⚠ 警告

- 本产品仅设计为家用，厂家对任何商用或不遵照说明操作而造成的后果不进行保修。
- 插头仅能连接带接地的插座或总接地的插板，建议不要使用延展线板。
- 请核对产品规格标贴上显示的电压与主电压是否一致。
- 请始终将养生壶放置在平坦、稳固、耐热的工作台上。
- 请将养生壶和电源线远离高温、潮湿、光滑的台面或锋利的边缘。
- 必须盖好盖子且放置好底座才能将养生壶放置在底座上使用。
- 手沾水或赤脚时禁止使用养生壶。

注意事项

⚠注意

- 请不要将养生壶及底座放置在高温台面或靠近明火的地方使用。
- 如发现养生壶不能正常工作，请立即拔掉电源插头。
- 请不要通过拉电源线来拔掉电源插头。
- 请不要让电源线悬挂在桌子或工作台面边缘之外，以防养生壶摔落。
- 使用时请注意，请勿让壶身或炖盅直接碰撞到硬物，以防玻璃被撞裂。
- 养生壶工作时，表面温度较高，请勿触碰壶身、壶盖金属、支架金属、玻璃炖盅，谨防烫伤。
- 养生壶工作时请不要揭开壶盖或移动养生壶，否则可能会被烫伤。
- 养生壶要防潮、防冻。
- 请不要将养生壶放进冰箱。
- 长时间不使用养生壶或清洁养生壶时请将插头拔除。
- 如果长时间不使用养生壶，建议将养生壶内的水倒掉。
- 请不要用非推荐的方法除水垢，推荐方法详见P20。
- 此产品不适用于身体或智力受限的人群（包括儿童），或缺乏经验和知识的人群，除非有人监督和引导，并保证其安全。请勿让儿童接触玩耍。
- 请不要在加水及食材超过最大水位，或低于最低水位时使用。养生壶内装水或食材过满，水在沸腾的时候可能会溅出。
- 本产品必须和其配套的底座一起使用，请勿使用其它底座。
- 电源线或插头损坏时禁止使用养生壶，为避免危险，请前往北鼎授权的服务中心进行更换或维修。
- 如果您的产品已损坏或不能正常使用，请勿继续使用，也勿自行拆除，建议您送检产品。
- 除了按照说明书进行清洁和除垢，其它任何非正常使用操作必须由北鼎授权的服务中心进行。
- 厂商仅对生产瑕疵和家用进行保修，未按照说明书操作造成的损坏不属于保修范围。
- 由于未对养生壶进行除垢造成其不能正常使用或完全不能使用的，不属于保修范围。
- 因为所有产品均严格按照质量控制程序，其中包括对随机抽检产品的实际使用测试，所以其将对产品的任何使用痕迹作出解释。

技术规格

产品名称：多功能电水壶（养生壶）

产品型号：K157

产品功率：1000W

电 压：220V~50Hz

最大容量：1.5L

执行标准：GB4706.1-2005/GB4706.19-2008

本产品采用食品接触用SUS304及SUS316L不锈钢

认识产品

产品结构图

- | | |
|---------------|-------------------|
| 1. 茶篮盖 | 7. 炖功能旋钮 |
| 2. 过滤茶篮 | 8. 支架外盖 |
| 3. 壶盖 | 9. 玻璃炖盅内盖（德国肖特玻璃） |
| 4. 壶身（德国肖特玻璃） | 10. 玻璃炖盅（德国肖特玻璃） |
| 5. 把手 | 11. 炖盅支架 |
| 6. 操作按键底座 | |

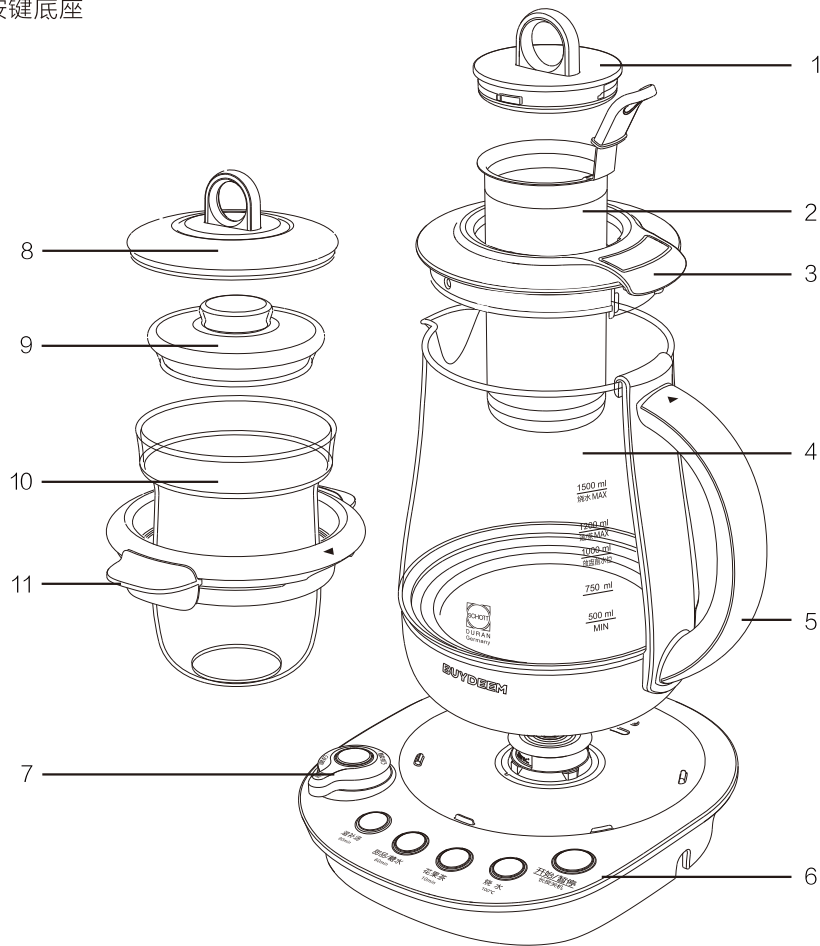

功能模式介绍

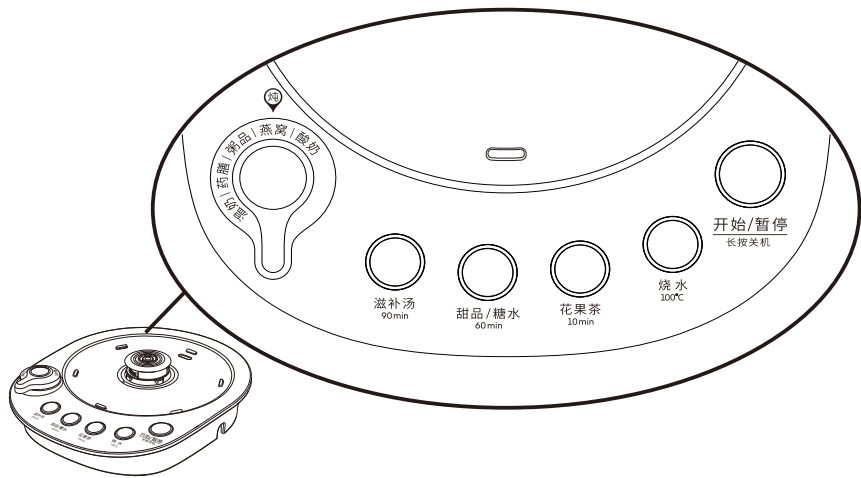

开始/暂停（长按关机）

此按键长亮表示工作，闪烁表示暂停。
在养生壶工作时，可按下此按键，“开始/暂停”按键闪烁，养生壶暂停工作，再按下此按键，“开始/暂停”按键亮，养生壶开始工作。
若需要取消已设定的功能或关机，可长按此按键2秒，按键灯全灭，养生壶停止工作，进入待机状态。
养生壶开始工作1分钟后，若需切换其它功能模式，可按一下“开始/暂停”键，再选其它功能。

烧水

此功能用于烧水。若选择此功能，养生壶快速烧水至沸腾，水沸腾后，养生壶发出“哔”声提示音，表示工作完成，同时自动停止工作，进入待机状态。

花果茶（10 分钟）

此功能用于烹煮花草茶，水果茶，普洱茶等。若选择此功能，养生壶将快速将水烧至沸腾，按照花果茶模式工作10分钟，程序结束，养生壶发出“哔”声提示音，表示工作完成，同时自动保温70摄氏度，保温2小时。2小时后，养生壶完全停止，进入待机状态。

甜品 / 糖水（60 分钟）

此功能用于烹煮豆类，红枣，莲子等糖水。若选择此功能，养生壶将快速烧开水至沸腾，再按照甜品/糖水模式工作1小时，程序结束后，养生壶发出“哔”声提示音，表示工作完成，同时自动保温70摄氏度，保温2小时。2小时后，养生壶完全停止，进入待机状态。

滋补汤（90 分钟）

此功能用于烹煮肉类，薏米等滋补汤类。若选择此功能，养生壶将快速烧开水至沸腾，再按照滋补汤模式工作1.5小时，程序结束后，养生壶发出“哔”声提示音，表示工作完成，同时自动保温70摄氏度，保温2小时。2小时后，养生壶完全停止，进入待机状态。

炖功能旋钮（以下功能请配合炖盅使用）

温奶（60°C / 10 分钟）

此功能用于配合炖盅使用来温热牛奶，以便饮用。若选择此功能，养生壶会加热壶中的水并将壶中的水维持在60摄氏度。10分钟后，养生壶发出“哔”声提示音，表示工作完成，进入待机状态。

药膳（120 分钟）

此功能用于配合炖盅使用来炖石斛，灵芝等药膳。若选择此功能，养生壶将快速将水烧至沸腾，再按照药膳的程序工作2小时。程序结束后养生壶发出“哔”声提示音，表示工作完成。同时自动保温70摄氏度，保温2小时。2小时后，养生壶完全停止，进入待机状态。

粥品（60 分钟）

此功能用于配合炖盅使用来炖小米粥，蔬菜粥等粥品。若选择此功能，养生壶将快速将水烧至沸腾，再按照粥品的程序工作1小时。程序结束后养生壶发出“哔”声提示音，表示工作完成。同时自动保温70摄氏度，保温2小时。2小时后，养生壶完全停止，进入待机状态。

燕窝（30 分钟）

此功能专门用于配合炖盅使用来炖燕窝。若选择此功能，养生壶将快速将水烧至沸腾，再按照燕窝程序工作30分钟。程序结束后养生壶发出“哔”声提示音，表示工作完成，同时自动停止工作，进入待机状态（为避免燕窝化水，燕窝功能无自动保温）。

酸奶（40°C / 12 小时）

此功能用于配合炖盅使用来制作酸奶。若选择此功能，养生壶会加热壶中的水并将壶中的水温维持在40摄氏度，同时按照酸奶的程序保温12小时。程序结束后养生壶发出“哔”声提示音，表示工作完成，同时自动停止工作，进入待机状态。

过滤茶篮介绍

盖中盖设计

养生壶按照用户日常使用习惯，加入两个盖子相互嵌套的“盖中盖”独特设计。在养生壶正常工作时，用户可随时通过拧开茶篮盖来观测食物烹煮状态，从而选择加料或调味等各种操作。若食物烹煮时产生了非常多的泡沫，建议打开茶篮盖，可有效防止溢出情况的出现。

1. 过滤茶篮安装：①抓住茶篮提手，把茶篮放入壶盖中空部分，②顺时针拧紧茶篮盖，当听到一声轻微“嘀嗒”声时，表示已经拧紧。

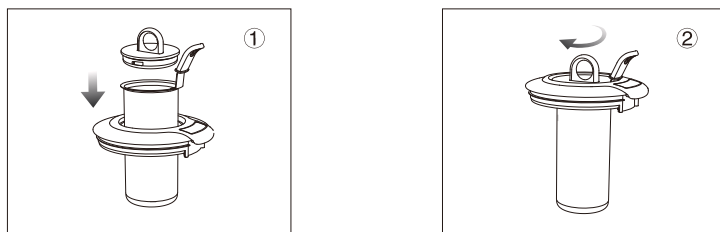

2. 过滤茶篮拆卸：①把茶篮盖逆时针拧开，②抓住茶篮提手，提出茶篮。

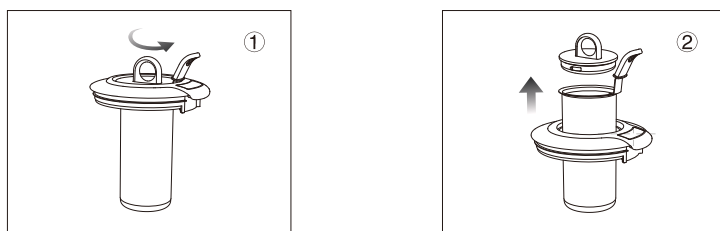

玻璃炖盅介绍

炖盅设计

养生壶为满足用户更全面的日常使用需求，另外加入了支架式炖盅的独特设计。用户可通过炖盅隔水炖煮食物，玻璃材质炖盅可直接观测食物烹煮状态。

⚠ 注意：请勿在使用炖盅支架的情况下进行倒水操作，以免炖盅与支架掉落造成烫伤危险。

1. 玻璃炖盅安装：①将炖盅置于支架内，②将支架连炖盅一起提起，③安装在养生壶上并盖上支架外盖，④当支架三角标识与壶身把手三角标识对齐时，说明已经安装完成。

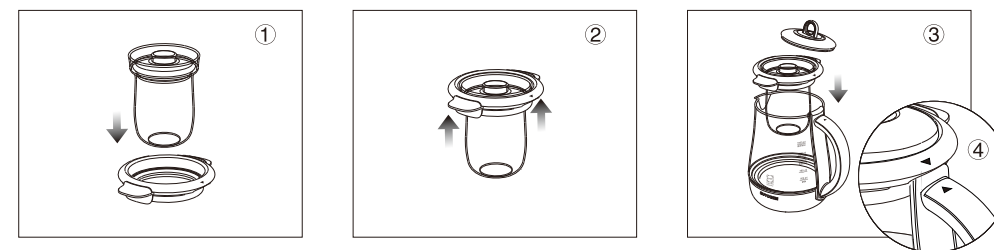

2. 玻璃炖盅拆卸：①提起支架连炖盅一起取出，②轻轻放下支架，③拿走支架外盖，取出炖盅。

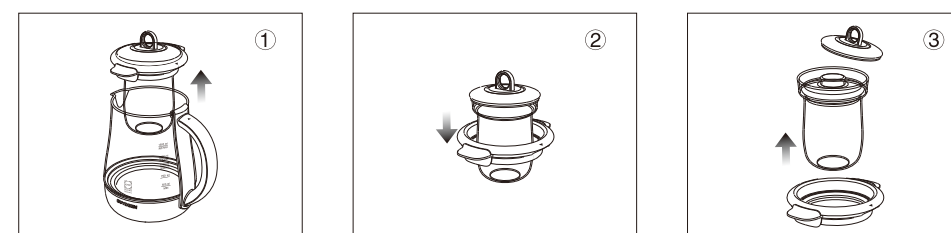

初次使用

1. 去除养生壶内外所有包装，标签及附件。在初次使用产品之前，我们建议您做一次沸点检测操作（详见P17）。
2. 前2-3次煮水应倒掉用于清洁，然后用湿布擦拭养生壶部件的外部。

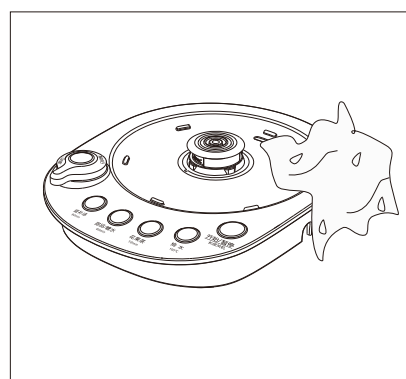
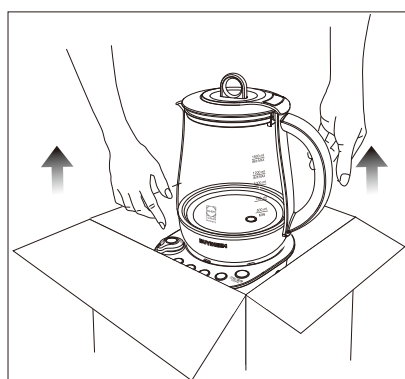

快速安装

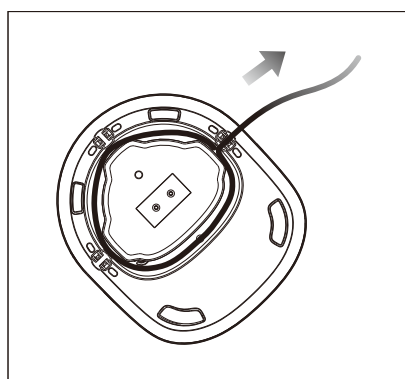

1. 通过底座的绕线装置调整电源线的长度。

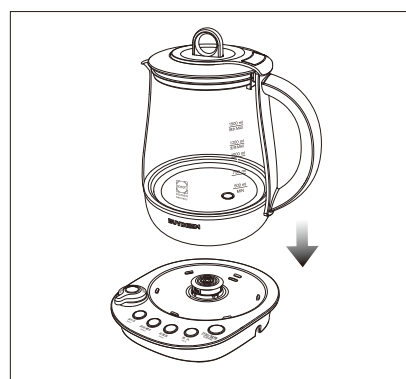

2. 将养生壶放到底座上。

使用指引

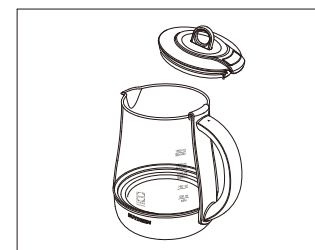

一、打开壶盖

- 拉紧壶盖提手，向上拉即可打开壶盖。

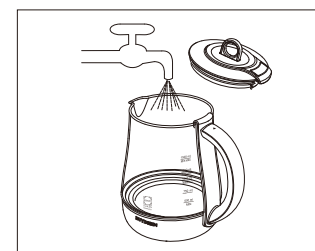

二、加入适量的净水

- 当养生壶在底座上时勿加水。



三、加入食材

- 切勿加水和食材超过最大水位或低于最小水位。
- 若加水过满，沸腾时可能会溅出水。
- 请注意，对于银耳、黄芪、黑茶等容易起泡的食材，建议加水到1200ml水位线即可。并在烹煮时打开壶盖。

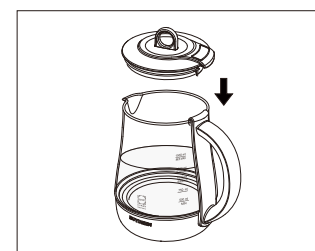

四、盖紧壶盖

- 将壶盖按图示位置放在壶身上，轻轻按压使壶盖合紧，用手轻轻提起，若提不起，表示盖子合紧。
- 如盖子装配不到位，倒水时，盖子容易掉下来。

使用指引



五、如需使用玻璃炖盅

- 将食物放入炖盅内，加入适量的水，按P8页所示安装好炖盅。

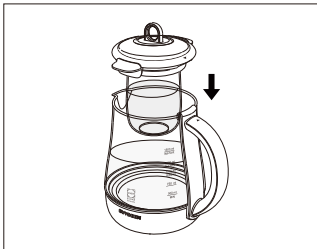

六、安装壶盖

- 将支架连炖盅提起，安装在养生壶上。
- 请注意！请确认支架上三角标识对齐壶身把手上的三角标识，否则说明炖盅支架没安装好。

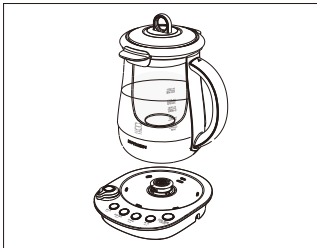
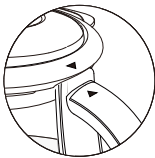

七、将养生壶放在底座上

- 请将壶底及底座面上的水擦干。
- 底座务必放置在平坦、干净的耐热台面上。
- 养生壶壶身必须使用专属的底座。
- 养生壶内无水时请勿使用。

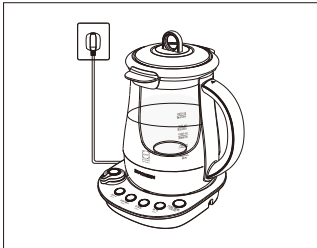

八、插上电源

- 当养生壶通电，蜂鸣器发出响声，按键灯闪烁后灯灭，
- 表示进入待机状态，可开始选择功能工作。

烧水

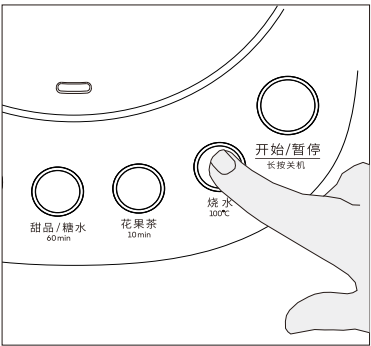

此款养生壶有两种方式进入烧水模式：

1.按“烧水”按键，再按“开始/暂停”按键，开始烧水模式

提示：按“烧水”按键，“烧水”按键灯亮，“开始/暂停”按键闪烁，提示需按压“开始/暂停”按键，再按“开始/暂停”按键，“开始/暂停”按键灯亮，养生壶进入烧水模式。

2.按“开始/暂停”按键，再按“烧水”按键，开始烧水模式

提示：先按“开始/暂停”按键，“开始/暂停”按键灯亮，其他功能按键灯均闪烁一次后灯灭，提示可开始选择功能，再按“烧水”按键，“烧水”按键灯亮，养生壶进入烧水模式。

花果茶

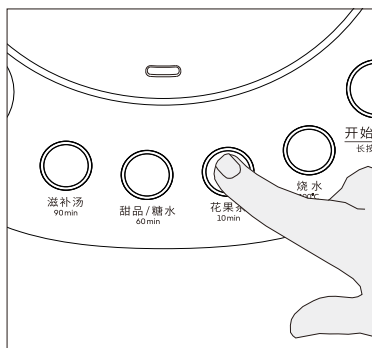

此款养生壶有两种方式进入花果茶模式：

1.按“花果茶”按键，再按“开始/暂停”按键，开始花果茶模式。

提示：按“花果茶”按键，“花果茶”按键灯亮，“开始/暂停”按键闪烁，提示需按压“开始/暂停”按键，再按“开始/暂停”按键，“开始/暂停”按键灯亮，养生壶进入花果茶模式。

2.按“开始/暂停”按键，再按“花果茶”按键，开始花果茶模式。

提示：先按“开始/暂停”按键，“开始/暂停”按键灯亮，其他功能按键灯均闪烁一次后灯灭，提示可开始选择功能，再按“花果茶”按键，“花果茶”按键灯亮，养生壶进入花果茶模式。

甜品/糖水

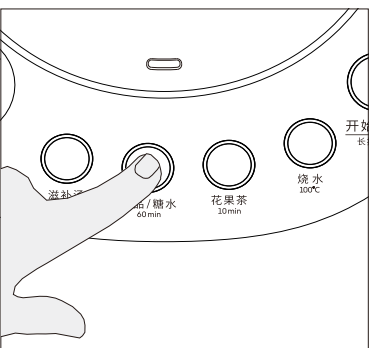

此款养生壶有两种方式进入甜品/糖水模式：

1.按“甜品/糖水”按键，再按“开始/暂停”按键，开始甜品/糖水模式。

提示：按“甜品/糖水”按键，“甜品/糖水”按键灯亮，“开始/暂停”按键闪烁，提示需按“开始/暂停”按键，再按“开始/暂停”按键，“开始/暂停”按键灯亮，养生壶进入甜品/糖水模式。

2.按“开始/暂停”按键，再按“甜品/糖水”按键，开始甜品/糖水模式。

提示：先按“开始/暂停”按键，“开始/暂停”按键灯亮，其他功能按键灯均闪烁一次后灯灭，提示可开始选择功能，再按“甜品/糖水”按键，“甜品/糖水”按键灯亮，养生壶进入甜品/糖水模式。

滋补汤

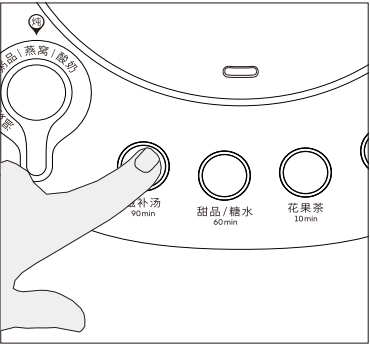

此款养生壶有两种方式进入滋补汤模式：

1.按“滋补汤”按键，再按“开始/暂停”按键，开始滋补汤模式。

提示：按“滋补汤”按键，“滋补汤”按键灯亮，“开始/暂停”按键闪烁，提示需按“开始/暂停”按键，再按“开始/暂停”按键，“开始/暂停”按键灯亮，养生壶进入滋补汤模式。

2.按“开始/暂停”按键，再按“滋补汤”按键，开始滋补汤模式。

提示：先按“开始/暂停”按键，“开始/暂停”按键灯亮，其他功能按键灯均闪烁一次后灯灭，提示可开始选择功能，再按“滋补汤”按键，“滋补汤”按键灯亮，养生壶进入滋补汤模式。

炖功能

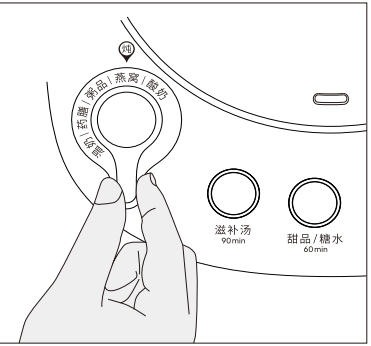

此款电水壶有两种方法使用炖功能旋钮，启动对应炖功能。

以“燕窝”功能为例：

1.旋转旋钮至“燕窝”位置，再按“开始/暂停”按键，开始燕窝模式。

提示：旋转旋钮至“燕窝”位置，“炖功能旋钮”按键灯亮，“开始/暂停”按键闪烁，再按“开始/暂停”按键，“开始/暂停”按键灯亮，养生壶进入燕窝模式。

2.按“开始/暂停”按键，再旋转旋钮至“燕窝”位置，开始燕窝模式。

提示：按“开始/暂停”按键，“开始/暂停”按键灯亮，其他功能按键灯均闪烁一次后灯灭，再旋转旋钮至“燕窝”位置，“炖功能旋钮”按键灯亮，养生壶进入燕窝模式。

沸点检测记忆程序

- 由于在非零海拔地区，水在沸腾时无法达到100℃，这将导致普通养生壶无法正常工作（跳断过慢甚至无法正常跳断）。
 - 为保证高原用户的良好使用体验，北鼎养生壶采用了行业内先进的“沸点检测技术”，内置可记忆存储芯片，只需执行一次沸点检测操作，即可在高原地区正常使用。
 - 沸点检测不限于高原地区，也适用于普通平原或山地地区。经过沸点检测后，养生壶能更精准的工作（性能比出厂设置时更佳）。北鼎建议您在第一次使用时，均进行一次沸点检测操作。检测完成后，芯片将记录精确沸点数据，再次使用无需重复检测。
- *若您处于海拔高于250m的城市，请必须进行沸点检测操作后再使用。

海拔高于250m的主要城市表

城市	海拔（米）	城市	海拔（米）	城市	海拔（米）
拉萨	3658	香格里拉	3280	格尔木	2808
丽江	2418	西宁	2261.2	昆明	1891.4
兰州	1520	银川	1111.5	贵阳	1071.2
呼和浩特	1063	乌鲁木齐	917.9	太原	777.9
成都	505.9	西安	396.9	重庆	259.1

启动沸点检测

1. 加入至1200ml水，水量不足或过多时，会影响检测结果。

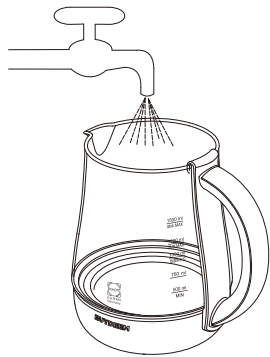

2. 放入线座，先不通电。

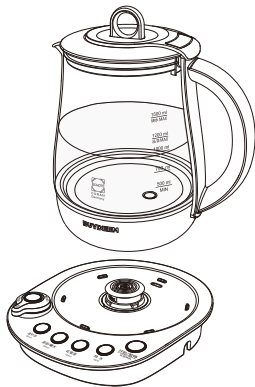

3. 同时按住“烧水”和“花果茶”键，按住按键的同时，把插头插入电源。待机器短鸣一声之后，即可松开按键。

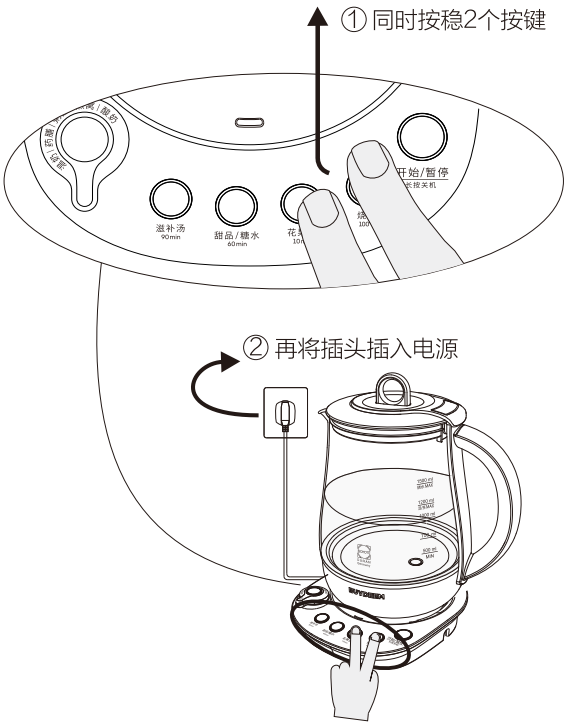

4. 此时“开始/暂停”的灯圈闪烁，按一下“开始/暂停”键。所有按键指示灯轮番闪烁。此时机器已进入检测状态，长鸣三声后，沸点检测工作自动完成后，即可正常使用养生壶。

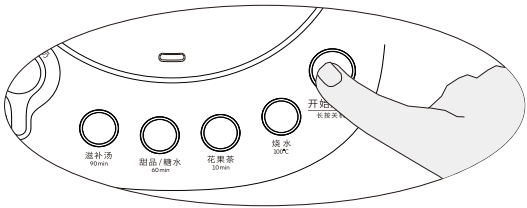

特色功能

提壶暂停记忆功能

养生壶按照程序进行工作时，可通过提壶或按“开始/暂停”来使其暂停工作，暂停1个小时内再通过放壶或按“开始/暂停”来开始工作，养生壶将执行暂停前未完成的程序时间，不会重新执行一遍功能程序。

避免误操作

- 养生壶按照所选功能模式进行工作的1分钟内：可任意切换模式。
- 为了避免误操作，养生壶开始工作1分钟后，不能随意切换功能。若需要切换功能，需先按“开始/暂停”按键，“开始/暂停”按键闪烁，再选择需要切换的程序。

冷水保护

- 在执行除“温奶”和“酸奶”的其他功能时，如在烹煮中途加入了冷水，养生壶会自动重新将水烧开后再执行尚未完成的程序。无需担心生冷隐患。

清洁和保养

清洁和保养

养生壶的清洗

- 1.拔下电源插头。
- 2.待养生壶冷却后，用湿海绵清洗养生壶内部。
注意:切勿将养生壶、底座、电源线或插头浸泡水中（壶底及底座上的电子连接器不可接触水）。
- 3.每次使用后，为避免食物变质，请及时清洗。

除水垢

养生壶需定期除水垢，至少每月一次，如水质较差则应增加次数。
发热盘如出现斑点，此为水垢，属于正常现象，用百洁布轻轻擦洗即可清洗干净。若情况较为严重，可采用以下方式进行除垢。

养生壶除垢小贴士

使用白醋：

- 往养生壶中倒入适量的白醋。
- 在不加热状态下静放1小时。
- 倒空养生壶后用清水清洗5-6次，必要时可重复。

使用柠檬酸：

- 倒入适量的水并煮沸。
- 加入25克柠檬酸并静放15分钟。
- 倒空养生壶后用清水清洗5-6次，必要时可重复。

简单故障处理

当养生壶放于底座，没有声音且按键灯不亮

- 检查养生壶是否完全连接底座。
- 检查底座是否完全连接电源。

信号音持续响且按键灯不亮

- 可能因为养生壶启动时没有加水或水垢堆积以致触动了干烧安全系统，可将养生壶冷却数分钟后，再倒入冷水。

水有异味

- 该情况一般出现在未使用过的新养生壶，前几次煮的水应倒掉。如果状况持续发生，将水注满至最高水位，并加两茶匙的苏打，煮沸后倒掉，再清洗养生壶。

保修和服务说明

- 如果产品有明细损坏，请您参看保修条件填好资料，将产品退回北鼎授权的售后服务中心修理，产品型号及序列号可见于产品底部。
- 保修仅限生产缺陷及参照说明书正确使用造成的损坏。
- 如果电源线损坏，为避免危险，必须由生产商、售后服务中心的专业人员进行维修或更换。
- 已过保修期限的顾客，如需购买产品零配件，可联系北鼎全国服务热线 4008-815-820。

以下情况恕不免费维修

- 无三包凭证及有效发票
- 未按说明书的要求操作引发的故障
- A. 消费者使用、保管、维护不当造成的损坏。
- B. 非本公司指定维修部自行装拆修理而造成的损坏。
- C. 因不可抗力造成的损坏。

北鼎保留对产品特性及组件作出修改的一切权利。

如果您需要更多的服务和信息，或有任何疑问，请访问北鼎网站 www.buydeem.com, 或致电北鼎全国服务热线4008-815-820，或与当地经销商联系。您也可以剪下保修卡填写资料，将产品寄回本公司，由本公司专业人员为您解决。